

Observers Training



Tracy McMillan
Modified from:
Kelly J. Clifton, PhD
Andréa D. Livi



Session Outline

- Introduction
- Street Segments & Survey Procedure
- Detailed Description of Each Question
- Practice Segments
- Discussion & Conclusion





Street Segments and Survey Procedure

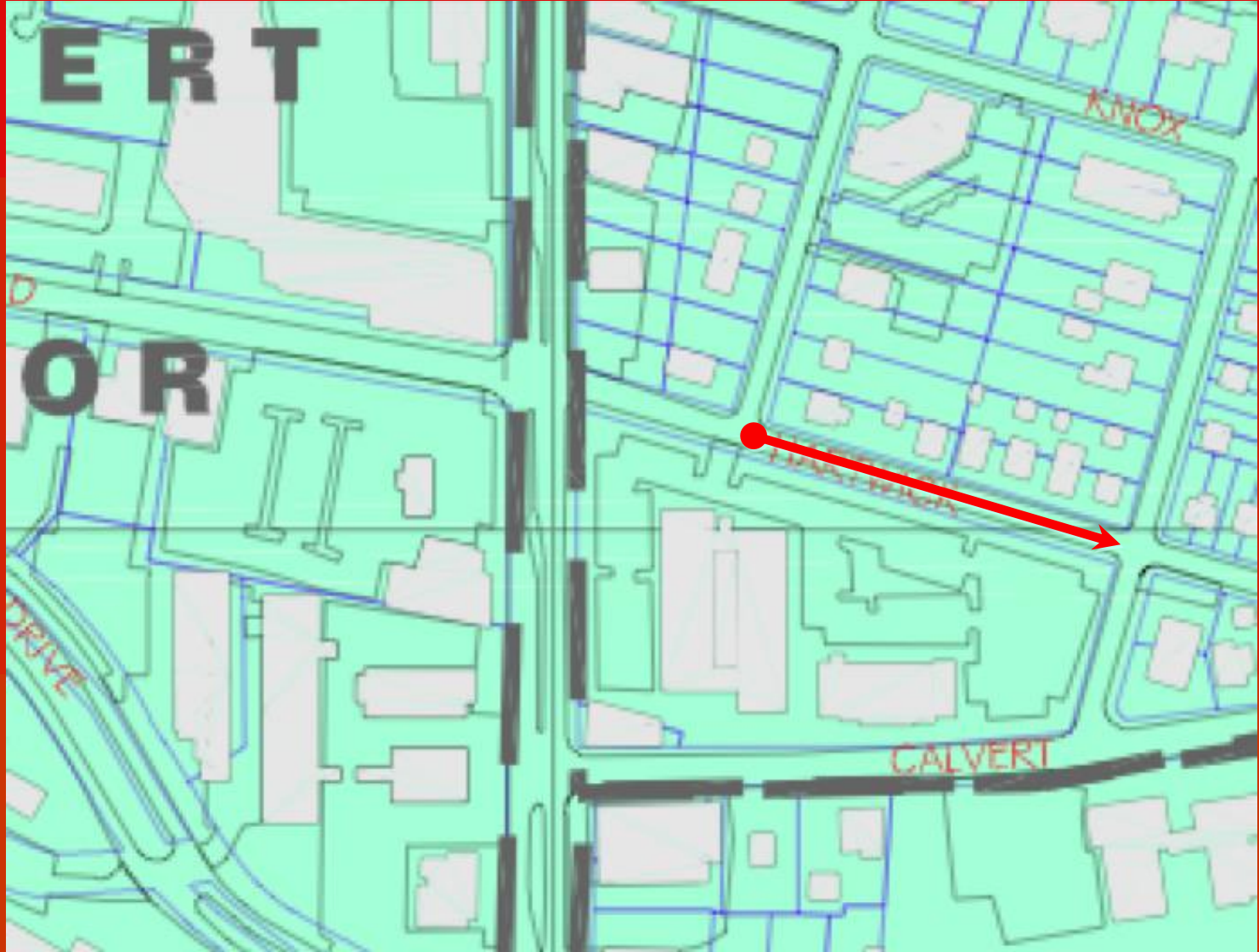

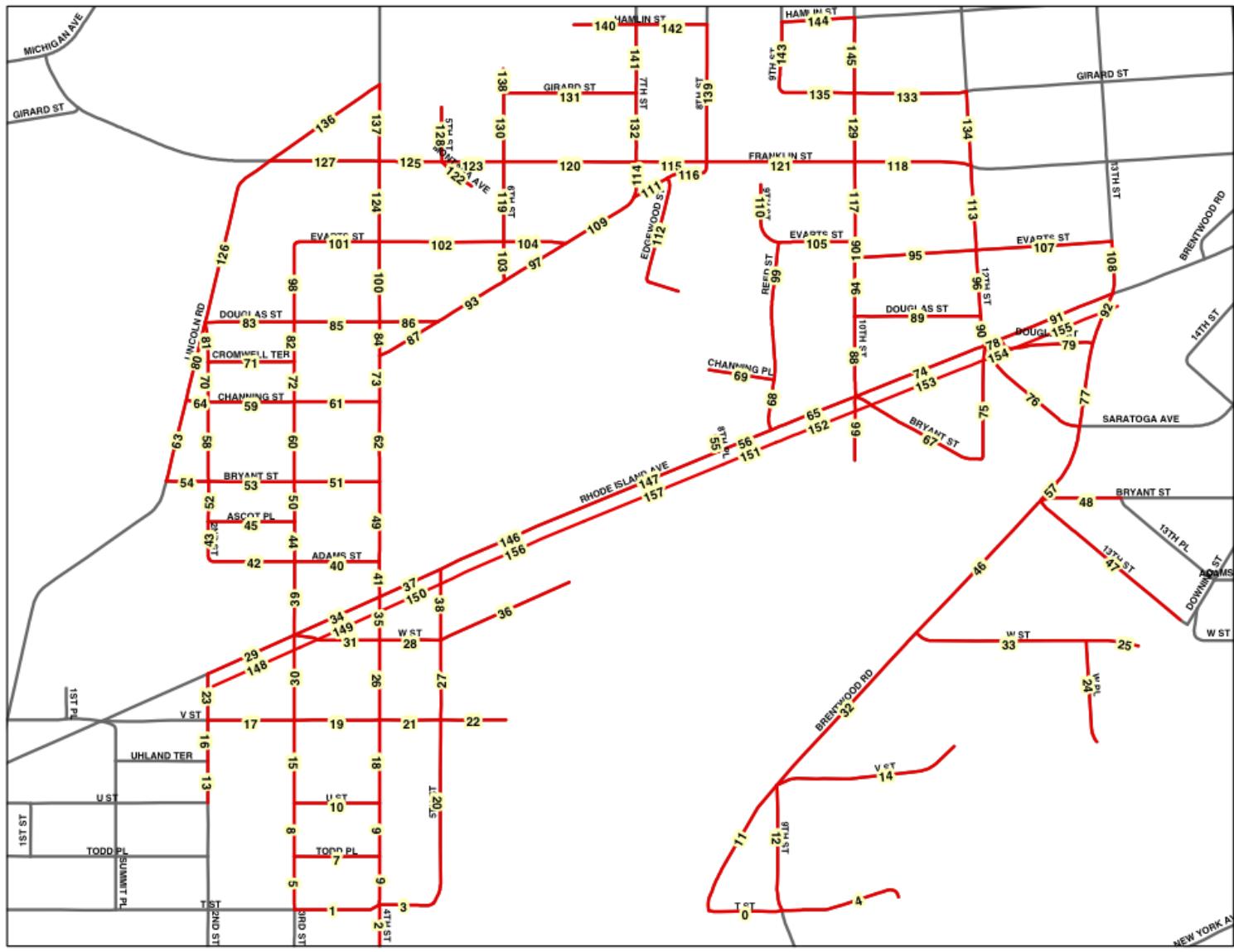



Detailed Description of Each Question

Questionnaire Sections

- ID Info
- Section O: Segment Type
- Section A: Environment
- Section B: Pedestrian Facility
- Section C: Road Attributes
- Section D: Walking/Cycling Environment
- Section SA: Subjective Assessment



Question 0

Type of Segment

- Low Volume Road (residential street)
- High Volume Road (arterials/collectors)
- Pedestrian Path (if answer this, then you will skip section C)



UNIV
O
MARY

TERRAPIN TRAIL





Section A: Environment

Question 1

Types of Buildings/Features

- Housing - Single Family
- Housing - Multi Family
- Housing - Mobile Home
- Office/Institutional
- Commercial/Restaurant
- Industrial
- Vacant/Undeveloped
- Recreation
- Surface parking lot
- School
- Area of worship

check all that apply



Q1 - Types of Buildings/Features

Single Family

Multi Family



Q1 - Types of Buildings/Features Mobile Homes



Q1 - Types of Buildings/Features

Office/Institutional

Commercial



Q1 - Types of Buildings/Features

Vacant



Recreation



Surface parking lot



Question 2

Slope

- Flat
- Slight Hill
- Steep Hill



Q2 - Slope Flat



Q2 - Slope Slight Hill



Q2 - Slope Steep Hill





Question 3

Segment Intersections

- Dead ends
- Segment continues
- Road ends, path continues

check all that apply



Segment intersections



Segment continues

Road ends,
path continues

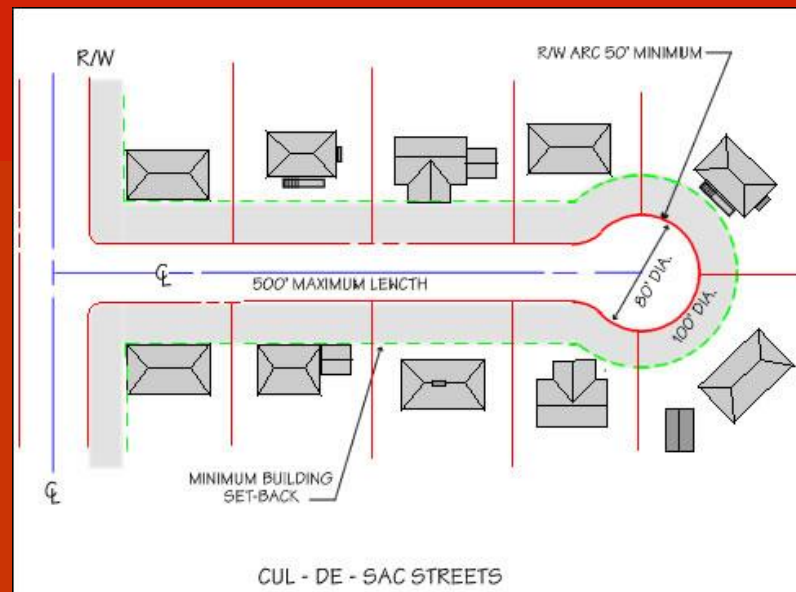

Road
dead ends
(cul de sac)





Section B: Pedestrian Facility

Question 4

Type(s) of Pedestrian Facility

- Footpath (worn dirt path)
- Paved Trail
- Sidewalk
- Pedestrian Street (closed to cars)
- None (skip to section C)



Q4 - Pedestrian Facility No Path



Q4 - Pedestrian Facility Trail/Footpath



Q4 - Pedestrian Facility Paved Trail



Q4 - Pedestrian Facility Sidewalk



Q4 - Pedestrian Facility Pedestrian Street



NOTE:

The rest of the questions in section B refer to the BEST pedestrian facility in the segment.



Question 5

Path Material

- Asphalt
- Concrete
- Paving Bricks or Stone
- Gravel
- Dirt or Sand

check all that apply



Q5 - Path Material Asphalt



Q5 - Path Material Concrete



Q5 - Path Material Paving Bricks or Stone



Q5 - Path Material Gravel



Q5 - Path Material Dirt or Sand



Question 6

Path Condition/Maintenance

- Poor (many bumps, cracks, holes and weeds)
- Fair (some bumps, cracks, holes and weeds)
- Good (very few bumps, cracks, holes and weeds)
- Under Repair



Q6 - Path Condition/Maintenance Poor



Q6 - Path Condition/Maintenance Fair



Q6 - Path Condition/Maintenance

Good



Question 7

Path Obstructions

- Poles or Signs
- Parked Cars
- Trees/Greenery
- Garbage Cans
- Other
- None

check all that apply



Q7 - Path Obstructions



Question 8

Buffers Between Road and Path

- Fence
- Trees
- Hedge
- Landscape
- Grass
- None

check all that apply



Q8 - Buffers Fence



Hedges



Q8 - Buffers Landscape



Grass



Q8 - Buffers

Trees and Grass



Question 9

Path Distance from Curb

- At Edge
- < 5 feet
- > 5 feet



Q9 - Distance from Curb



Question 10

Sidewalk Width

- < 4 feet
- 4 to 8 feet
- > 8 feet



Q10 - Sidewalk Width



> 8 feet



4-8 feet



Question 11

Curb Cuts

- None
- 1 to 4
- More than 4



Q11 - Curb Cuts



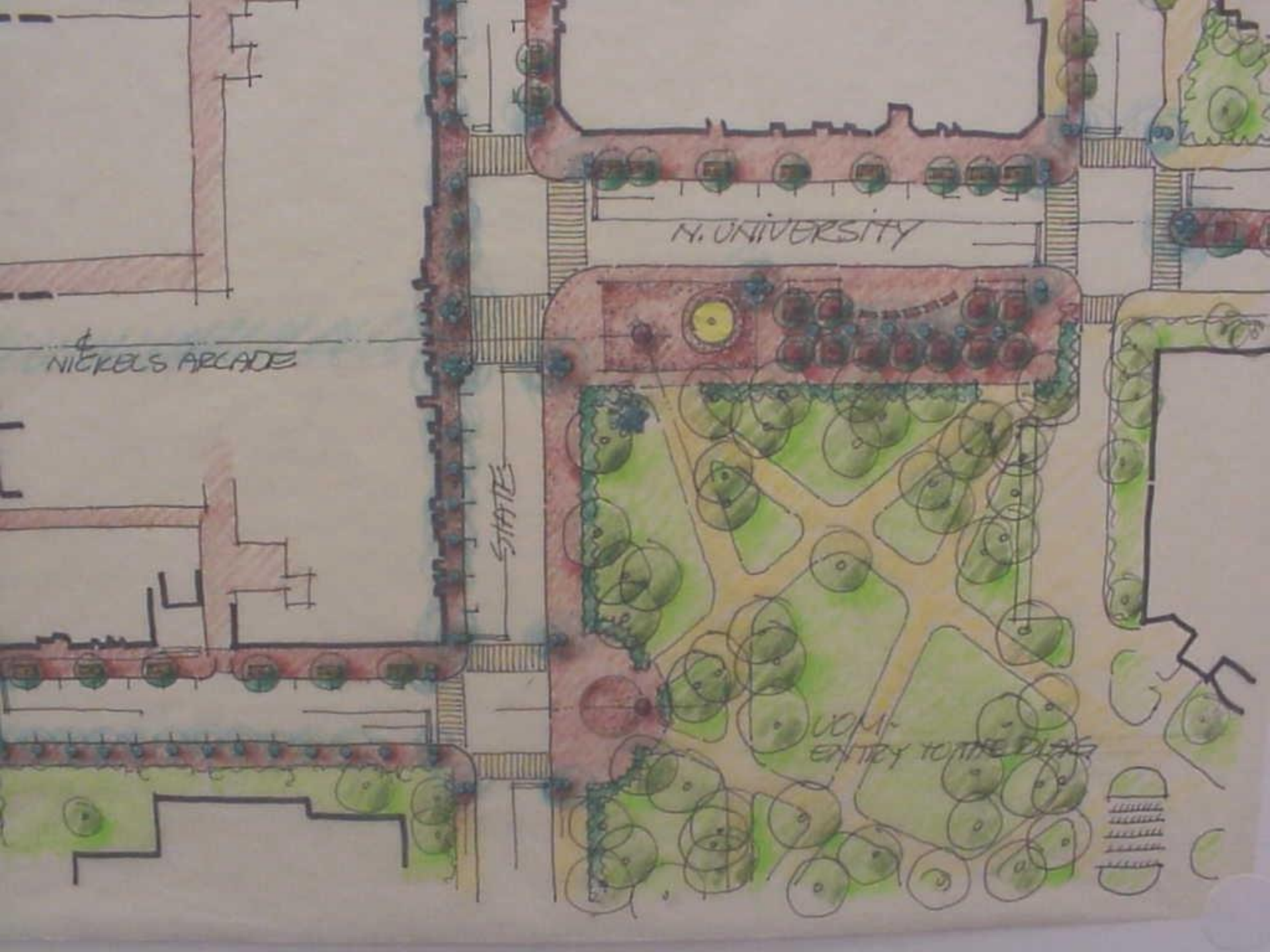

N. UNIVERSITY

NICKEL'S ARCADE

STATES

UNIV.
ENTRY TO THE DIXIE

Question 12

Sidewalk Completeness/Continuity

- Sidewalk is Complete
- Sidewalk is Incomplete



Q12 - Sidewalk Completeness/Continuity



A complete sidewalk is one that does not end **WITHIN** the segment that is being observed.

This sidewalk is incomplete.



Question 13

Connectivity to Other Sidewalks

- Number of Connections _____



Q13 - Sidewalk Connectivity

